

36” Combination Gas Ranges

Standard Features

- Stainless steel exterior including front, back sides, kick plate, back guard and over shelf
- 36” combination ranges with either a 24” griddle top with 2 burners
- Heavy duty 3/4” thick polished steel griddle plate
- Drip tray provided under burners to catch grease drippings
- 32,000 BTU top burners, 27,000 BTU griddle & 27,000 BTU oven burners
- Oven temperature range between 175°F to 550°F
- Standing pilot for open top burners
- Oven pilot with 100% safety shut off
- Enamel interior oven for easy cleaning
- Multiple position oven rack guides
- Two(2) chrome oven racks per oven standard
- Available in Natural and Propane
- 3/4” NPT rear gas connection and regulator provided
- Four(4) casters standard

Optional Accessories

- Leg kit part #: 301110006
- Extra oven rack part #: 301100012

MODELS:

AGR-2B24GR/AGR-2B24GL



AGR-2B24GR



AGR-2B24GL



1 YEAR PARTS AND LABOR WARRANTY



Conforms to ANSI
STD Z83.11b-2009 (2011)
Certified for CSA
STD 1.8B-2009 (2011)
Conforms to NSF/ANSI STD.4



REV. 05/23

“WE MAKE THE KITCHEN BETTER!”

SPECIFICATIONS

Models	Gas Type	Burner Name	BTU's	Number of Burners	Valve Types	Oven Size (inch)	Hot Plates Working Area(inch)	Griddle Working Area(inch)	Exterior Dimensions (inch)	Net Weight (lbs)	Gross Weight (lbs)
AGR-2B24GR	NG	Hot plates	64,000	2	Pilot light	26 ^{1/2} ×26×14	2pcs 11 ^{4/5} ×11 ^{4/5}	24×50 ^{5/8}	36×31×57 ^{3/8}	479	607
		Griddle	48,000	2							
		Oven	24,000	1							
	LP	Hot plates	46,000	2							
		Griddle	48,000	2							
		Oven	27,000	1							
AGR-2B24GL	NG	Hot plates	64,000	2	Pilot light	26 ^{1/2} ×26×14	2pcs 11 ^{4/5} ×11 ^{4/5}	24×50 ^{5/8}	36×31×57 ^{3/8}	479	607
		Griddle	48,000	2							
		Oven	24,000	1							
	LP	Hot plates	46,000	2							
		Griddle	48,000	2							
		Oven	27,000	1							

PLAN VIEW

AGR-2B24GR



AGR-2B24GL

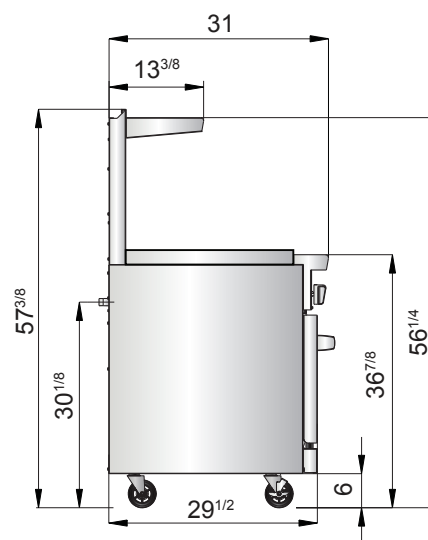
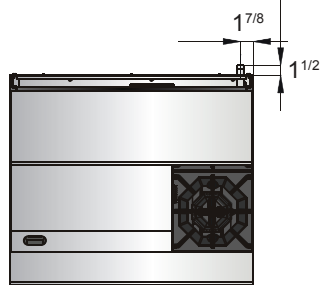
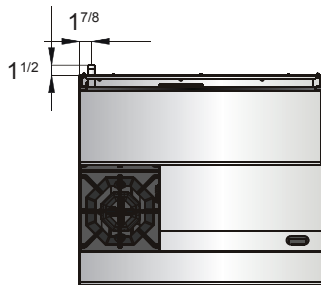

Heavy duty burners



Chrome oven rack



Stainless steel knobs



Stainless steel drawers



Logo

